

Marblehead Open Space & Recreation Plan 2012

APPENDICES

Appendix A: Requests for information

Sample letter to special interest organizations –

| |
|---|
| <p style="text-align: center;">TOWN OF MARBLEHEAD</p> <p style="text-align: center;">OPEN SPACE COMMITTEE</p> <p style="text-align: center;">ABBOT HALL</p> <p style="text-align: center;">MARBLEHEAD, MASSACHUSETTS 01970</p> <p style="text-align: right;">January 19, 2012</p> <p>Robert French Marblehead Conservancy Blueberry Rd. Marblehead, MA 01945</p> <p>Dear Bob,</p> <p>The Marblehead Open Space Committee is in the process of updating its Open Space and Recreation Plan. This Open Space and Recreation Plan is a comprehensive plan that contains the town's priorities and goals for open space and recreation and serves as a resource for recreational opportunities and a guide to parks and conservation lands. The town is required to have an Open Space and Recreation Plan and update it every five years in order to qualify for some state and federal funding programs.</p> <p>In an effort to gain public input into the plan, we will be conducting some surveys and public meetings. Additionally we are trying to reach out to groups like yours to obtain more meaningful feedback into the recreational and open space needs of the users. We would appreciate your filling out the enclosed survey and sending it back to us within a week. A member of the open space committee will be contacting you within a few days to arrange a convenient time for a brief interview.</p> <p>We have an ambitious goal to complete the plan by June 30. We hope you will join us in our enthusiasm for this very worthwhile project. In the meantime should you have any questions, please feel free to call Rebecca Curran Town Planner at 781 631-0000.</p> <p>Thank you in advance for your assistance in the preparation of this project.</p> <p>Very truly yours,</p> <p>Rebecca Curran For the Open Space Committee</p> |
|---|

Survey of Individuals –

THE MARBLEHEAD OPEN SPACE & RECREATION SURVEY

Please fill out and submit – we need your feedback

This survey is being conducted by the Open Space Committee in order to determine the needs and concerns of the citizens of Marblehead. The Town needs this input to update its Open Space & Recreation Plan. This plan is necessary to qualify for state and federal programs for acquisition and expansion projects.

1. Which of the following public lands do you use regularly?

- ☐ Beacon Street land (corner of Green)
- ☐ Castle Rock
- ☐ Chandler Hovey Park
- ☐ Crocker Park
- ☐ Devereux Beach
- ☐ Forest River Conservation area
- ☐ Fort Beach
- ☐ Fort Sewall
- ☐ Fountain park
- ☐ Gas House Beach
- ☐ Gatchell Green
- ☐ Gatchell Park
- ☐ Gerry Playground (Stramski)
- ☐ Grace Oliver's Beach
- ☐ Hawthorne Road area
- ☐ High School Fields
- ☐ Hobbs playground
- ☐ Memorial Park
- ☐ Orne playground
- ☐ Redd's Pond
- ☐ Reynolds playground (Green Street park)
- ☐ Seaside Park
- ☐ Steer Swamp
- ☐ Railroad Right of Way (Path)
- ☐ Riverhead Beach
- ☐ Robinson Farm
- ☐ Turner Woods
- ☐ Veterans Memorial Middle School Fields
- ☐ Village School Fields
- ☐ Village Street pier
- ☐ Ware Pond
- ☐ Wyman Woods

2. Which site do you use most often?

- ☐ Beacon Street land (corner of Green)
- ☐ Castle Rock
- ☐ Chandler Hovey Park

- ☐ Crocker Park
- ☐ Devereux Beach
- ☐ Forest River Conservation area
- ☐ Fort Beach
- ☐ Fort Sewall
- ☐ Fountain park
- ☐ Gas House Beach
- ☐ Gatchell Green
- ☐ Gatchell Park
- ☐ Gerry Playground (Stramski)
- ☐ Grace Oliver's Beach
- ☐ Hawthorne Road area
- ☐ High School Fields
- ☐ Hobbs playground
- ☐ Memorial Park
- ☐ Orne playground
- ☐ Redd's Pond
- ☐ Reynolds playground (Green Street park)
- ☐ Seaside Park
- ☐ Steer Swamp
- ☐ Railroad Right of Way (Path)
- ☐ Riverhead Beach
- ☐ Robinson Farm
- ☐ Turner Woods
- ☐ Veterans Memorial Middle School Fields
- ☐ Village Street School
- ☐ Village Street pier
- ☐ Ware Pond
- ☐ Wyman Woods

3. How do you usually travel there?

- ☐ Walk
- ☐ Bus
- ☐ Bike
- ☐ Car
- ☐ Other

3. How long does it take you to travel there?

- ☐ 1 -5 Minutes
- ☐ 5-10 Minutes
- ☐ Over 10 Minutes

5. Do you feel that your opportunities for recreation programs in Marblehead are adequate?

- ☐ Yes
- ☐ No

6. Do you feel that Marblehead has enough conservation land?

- ☐ Yes
- ☐ No

7. Do you feel that Marblehead has enough areas that provide access to the coast?

- ☐ Yes
- ☐ No

8. Do you feel that Marblehead has enough recreation areas (playgrounds, fields?)

- ☐ Yes
- ☐ No

8. How satisfied are you with the places for children and youths to play recreate in Town?

- ☐ Very Satisfied
- ☐ Satisfied
- ☐ Neutral
- ☐ Dissatisfied
- ☐ Very Dissatisfied

9. How satisfied are you with the places available in town for recreation use by adults?

- ☐ Very Satisfied
- ☐ Satisfied
- ☐ Neutral
- ☐ Dissatisfied
- ☐ Very Dissatisfied

10. How important is it for the town to acquire and preserve conservation areas as natural areas?

- ☐ Very Important
- ☐ Important
- ☐ Neutral
- ☐ Not very important
- ☐ Not at all important

11. Please check the top 5 public recreational facilities you feel are needed:

- ☐ Bike trails
- ☐ Tennis courts
- ☐ Dog parks
- ☐ Fields - soccer, lacrosse, football
- ☐ Fields - baseball softball
- ☐ Ice skating rink – indoor
- ☐ Ice skating rink – outdoor
- ☐ Coastal access for boats
- ☐ Swimming pool - indoor
- ☐ Swimming pool - outdoor

12. Should the Town concentrate its efforts on:

- ☐ Maintaining current recreation areas and facilities?
- ☐ Acquiring additional conservation land?
- ☐ Acquiring additional recreation land?
- ☐ Place equal emphasis on

13. To preserve open space in town would you

- ☐ Contribute land to town?
- ☐ Donate money to buy land?
- ☐ Support proposition 2 ½ override?
- ☐ Sell land to the town at a reduced rate?

14. Do you think the town should expand opportunities for specific age groups?

- ☐ Preschool
- ☐ Older children
- ☐ Adults
- ☐ Senior citizens

15. How many years have you lived in Marblehead?

- ☐ 0-1
- ☐ 2-4
- ☐ 5-9
- ☐ 10-19
- ☐ 20-29
- ☐ 30+

16. What precinct do you live in?

- ☐ 1
- ☐ 2
- ☐ 3
- ☐ 4
- ☐ 5
- ☐ 6
- ☐ 7
- ☐ Don't know

17. How many children under 18 live in your household?

- ☐ 0
- ☐ 1
- ☐ 2
- ☐ 3
- ☐ 4
- ☐ 5+

18. Does a physically disabled person live in your household

- ☐ Yes
- ☐ No

Thank you for your assistance

Organization survey –

Marblehead Open Space Plan

ORGANIZATION SURVEY

NAME OF ORGANIZATION: _____

CONTACT PERSON: _____

Which property(ies) does your organization use?

For what purpose?

How often do you use this property(ies)? (daily, weekly, monthly)

What times of year do you use this property (ies)?

Are the areas adequate, good, or inadequate for your purposes?

What could be improved?

Appendix B – Survey Input

Appendix B-1: Items of specific interest received at public meeting, January 23, 2012 –

January 2012 Open Space meeting

- Develop a process for updating plan
- Establish an arboretum at waterside cemetery
- Designate a bike route throughout town
- Make Marblehead bicycling more friendly
- Explore and plan on establishing bike lanes on roads with appropriate widths
- Encourage bike racks (private)
- Install more public bike racks
- Examine tree department land on Vine Street for pedestrian link from rrow* to Veterans School
- Look at potential tree dept. land on Vine St. for potential other purposes (recreation)
- Acquire Lead Mills
- Eveleth School explore the reuse when vacant
- Look at school lands not used for school purposes
- Compile a list of potential land to acquire
- Look at the rrow* as connection to schools/parks/recreation
- Develop a plan for the maintenance of RRROW*
- RRROW* dumping and trash pick up policies
- Look at upgrading the path* for recreational purposes (currently un-inviting especially Besson and under Village Street)
- Coordinate with Swampscott on rrow* connection
- Work with Salem to examine extending path* from YMCA through Water & Sewer land to the Salem Forest River open space
- Pond at Legg's Hill Road – develop as an educational opportunity
- Fort Sewall Erosions project
- Memorial beach program – develop guideline for park land
- Look at Swampscott land next to pond by Legg's Hill Road
- Acquire Gerry Island
- Look at encroachments on rrow* ; work to publicize and keep open
- Measure adequacy of dog park usage
- Hamond nature center camp shore lea expanding programs
- Environmental education encourage school use of town property

*rrow = railroad right of way = the Path

Appendix B-2: Individual survey responses, compiled

Profile of responders –

Years Living in Marblehead

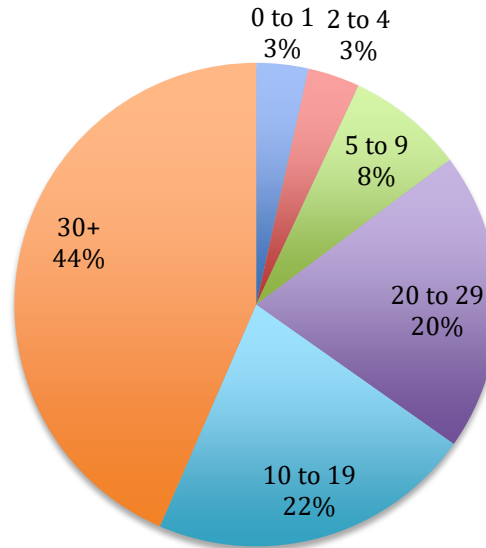

Children Under 18 in the Home

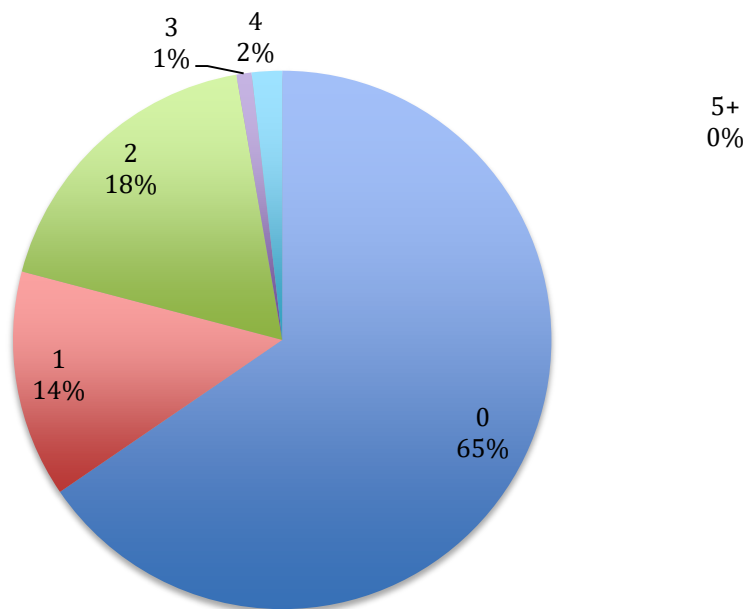

Precinct Represented

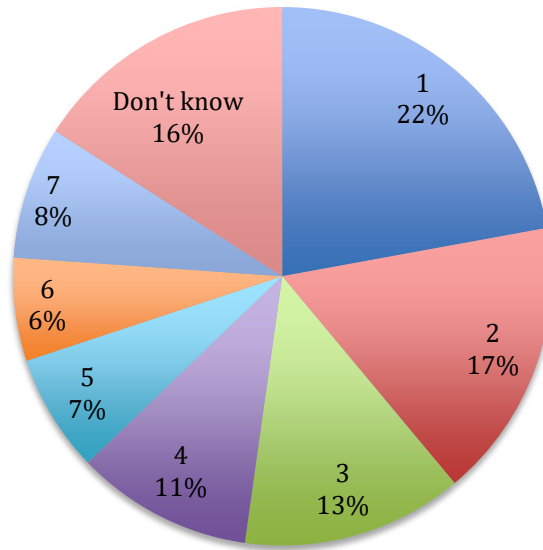

Does a physically disabled person live in your household?

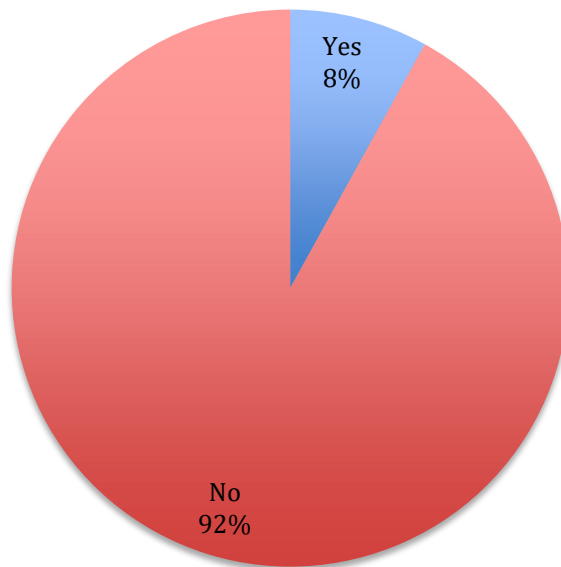

Most used Marblehead-Owned Open Spaces:

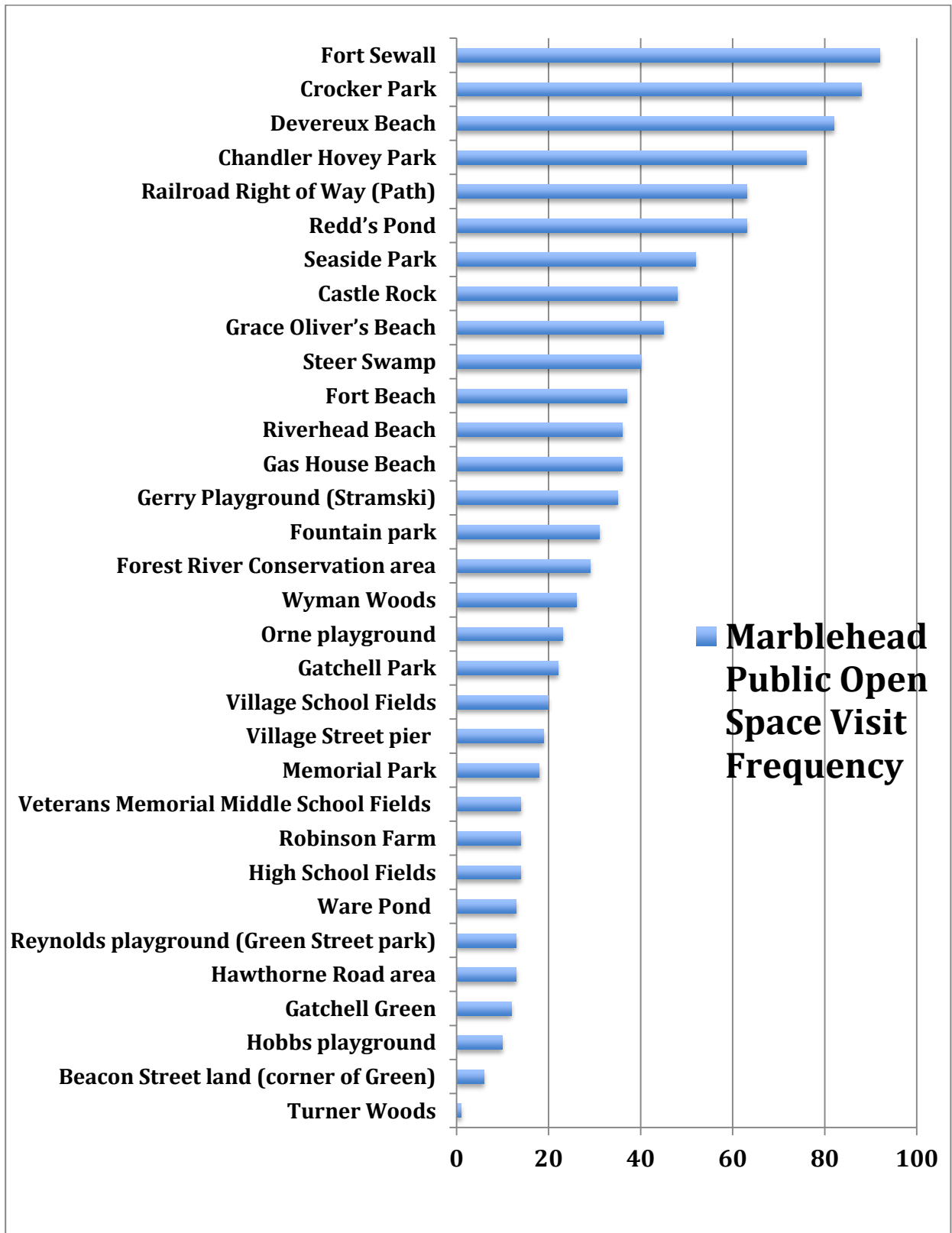

Questions regarding recreation –

**Should the Town expand
recreational opportunities for
specific age groups?**

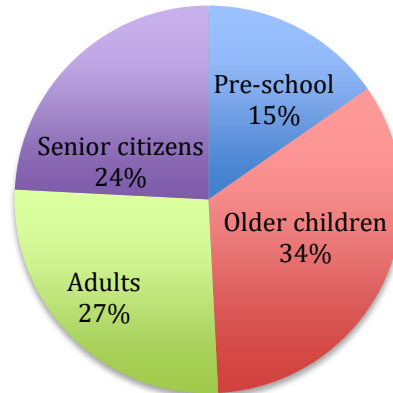

**Do you feel that
Marblehead has enough
recreation areas
(playground, fields)?**

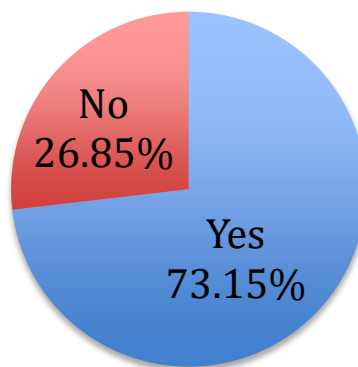

**Do you feel that
opportunities for
recreation
programs in
Marblehead are
adequate?**

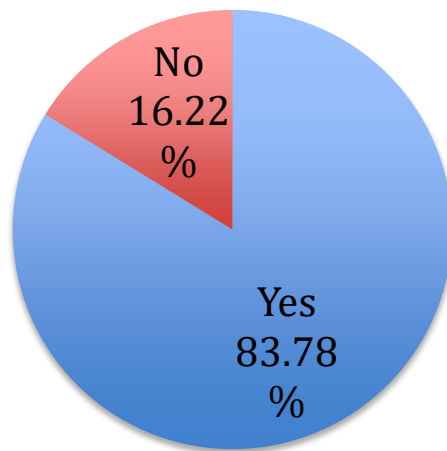

**Do you feel that
Marblehead has enough
areas that provide
access to the coast?**

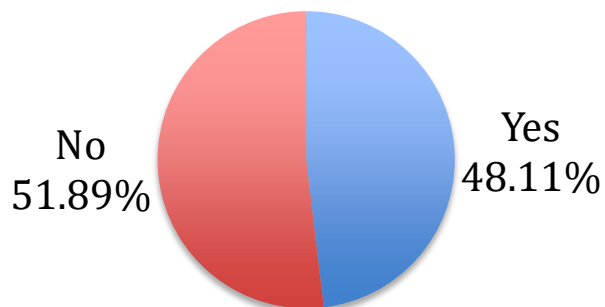

How satisfied are you with the places for children and youth to play and recreate in town?

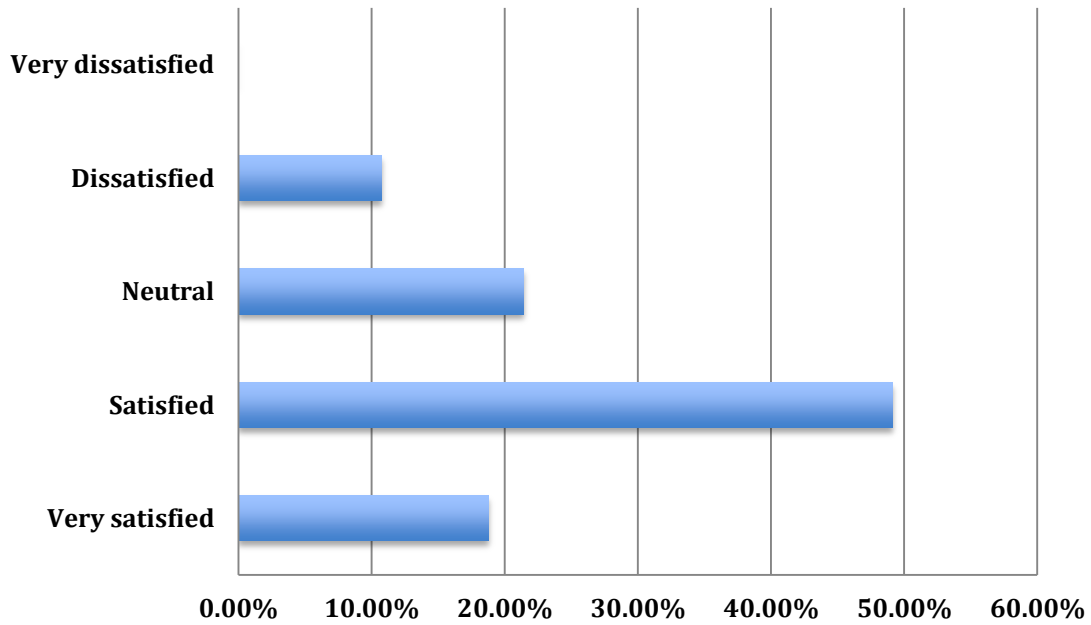

How satisfied are you with the places available in town for recreation use by adults?

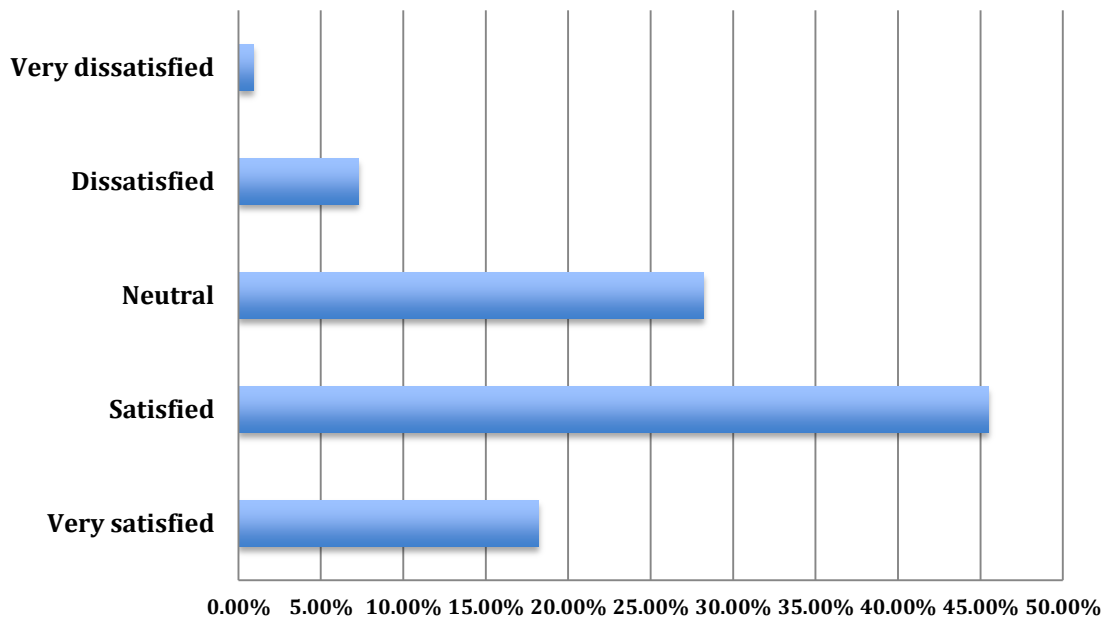

Public recreational facilities felt to be needed

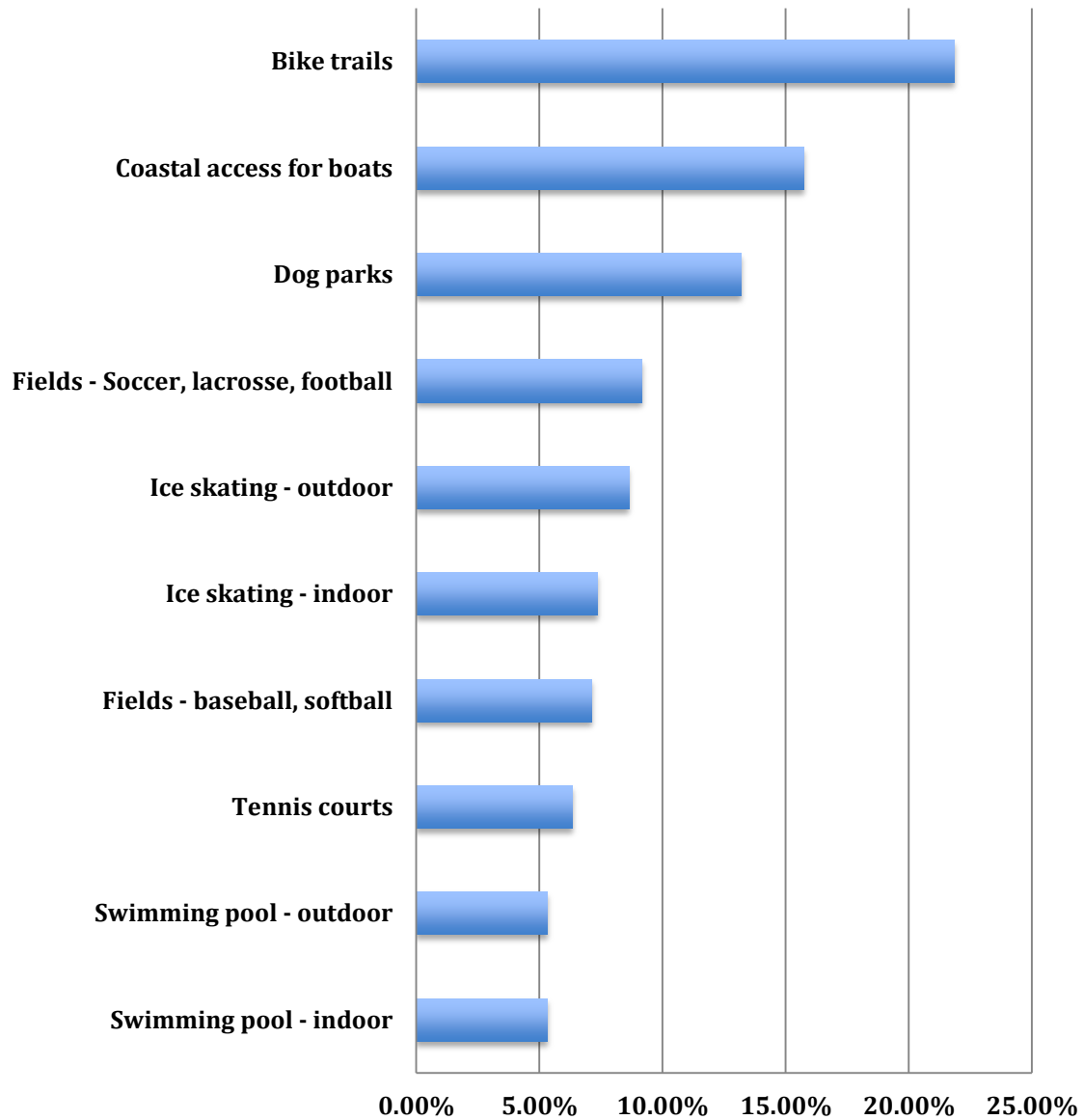

Questions regarding conservation land –

**Do you feel that
Marblehead has enough
conservation land?**

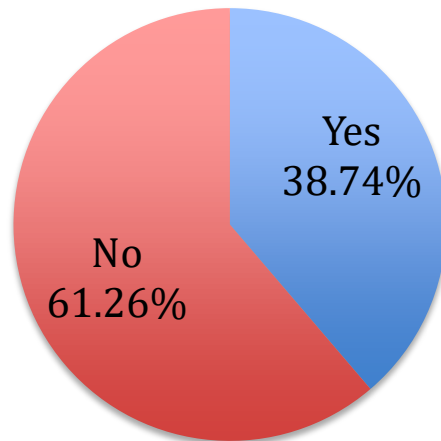

**How important is it for the town to
acquire and preserve conservation areas
as natural areas?**

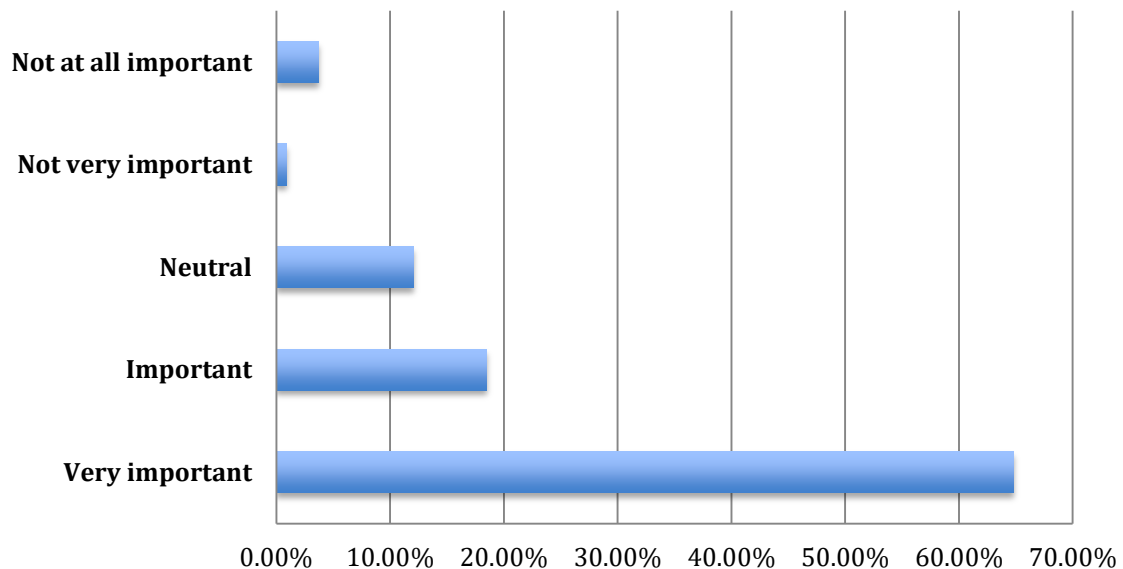

To preserve open space, would you:

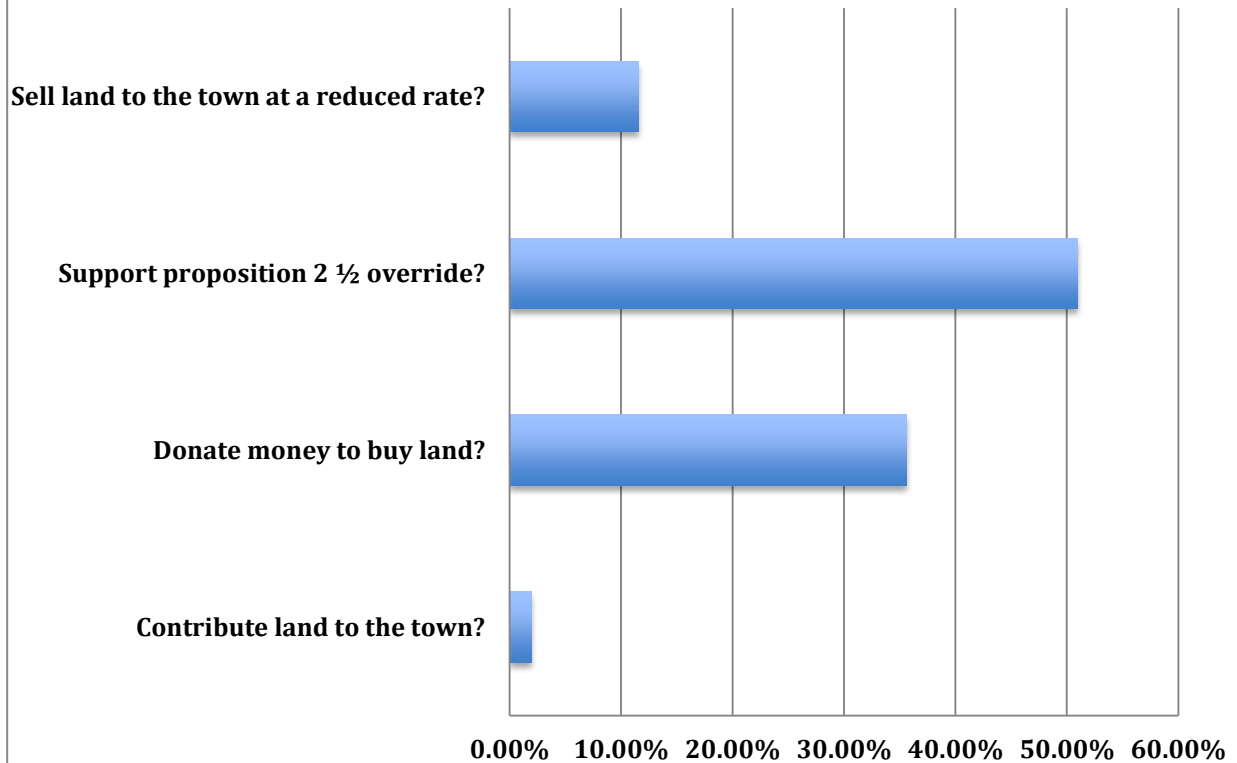

Should the town concentrate its efforts on:

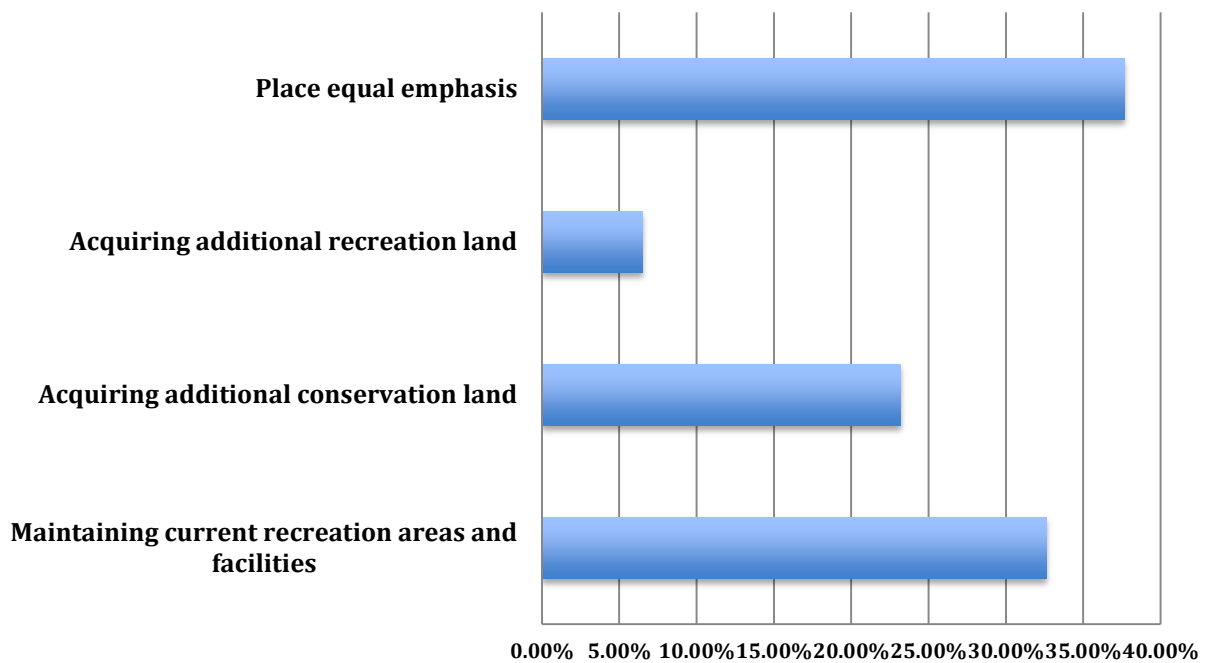

Appendix B-3: Organization issues and suggestions for improvement- Issues:

- Accessibility with ADA compliance
- Playgrounds
- Conservation areas
- Parking (3)
- Condition of recreation fields (3)
- Size of the recreation fields (2)
- Permitting process
- Invasive plants in ponds
- Noise
- Vandalism
- Free-running dogs
- Site overuse and improper use
- Connection to the former Swampscott rail bed
- Maintenance of park areas

Suggestions for improvement:

- Field turf and lighting – artificial turf
- Increase emphasis on passive recreation
- Handicapped-friendly apparatus at playgrounds
- Include Disability Commission in planning open spaces
- Orientation of the Village School fields (to suit sports played)
- Easy access (to deal with vandalism and risk of fire)
- Pond management structure
- Education of personal responsibilities in open space use
- Easy process for permitting
- Easy process for scheduling field use
- Beach clean-up
- Surfacing of the Path
- Removal of the bollards at the Path bridges
- Maintenance
- Stair repair at Fountain Park
- Re-painting
- Step repair at Old Burial Hill
- Fort repair at Fort Sewall
- Hydrant at Deveraux Beach
- Clear access road at Robinson Farm
- Field grass mowing
- Field leveling
- Parking area improvement (Gerry Playground)
- Cut vegetation along the Path more often
- Purchase Gerry Island to preserve coast

Appendix C – Conservation Commission Lands

| ACREAGE | DATE | ACQ FROM | ACQUIRED BY |
|----------------------|------|---------------------------------------|----------------|
| STEER SWAMP | | | |
| 3.78 | 1963 | Gertrude Howard | Gift |
| 0.35 | 1966 | Linton Bell | Gift |
| 2.66 | 1966 | Mortimer Brown | Gift |
| 1.84 | 1967 | William Crowninshield | Purchase |
| 4.01 | 1968 | Katherine Hammond & Emily Record | Gift/Purchase |
| 1.25 | 1971 | William Crowninshield | Purchase |
| 2.16 | 1971 | Robert Jannell | Purchase |
| 0.50 | 1971 | Rindge Estate | Purchase |
| 2.75 | 1972 | Earl Doliber | Purchase |
| 1.20 | 1972 | Barbara Hunneman & Charles Nyren | Purchase |
| 1.79 | 1972 | Thomas Barry | Purchase |
| 2.52 | 1972 | Kenneth Gelpy | Purchase |
| 15.78 | 1972 | Joseph Roche | Eminent domain |
| 0.1 | | Edward Martin | Gift |
| 0.79 | 1973 | Agnes Johnston | Purchase |
| 2.00 | | J.J. Storrow | Gift |
| WYMAN WOODS | | | |
| 12.28 | 1961 | Transferred by Selectmen Wyman family | Gift |
| 12.31 | 1972 | Marblehead Cliff Realty | Purchase |
| 2.2 | 1981 | Marblehead Trust | Purchase |
| 6.7 | 1981 | In memory of Azor Orne Goodwin | Gift |
| WARE POND | | | |
| 4.28 | 1965 | Ralph Sevinor Realty Trust | Gift |
| 3.50 | 1969 | Silverman & Klodny | Purchase |
| 0.72 | 1980 | Sevinor (30,600 sq. ft.) | Purchase |
| FOREST RIVER | | | |
| 26.0 | 1973 | Haley | Eminent Domain |
| HAWTHORN POND | | | |
| 3.10 | 1969 | Lauria & Risti | Purchase |

| | | | |
|----------------------|------|----------------------------|---------------------------------------|
| 1.29 | 1969 | Howard Knight | Gift |
| 0.32 | 1969 | Bertram Rice | Gift |
| 0.32 | 1969 | Donald Daley | Gift |
| 0.71 | 1969 | Bart O'Connor | Gift of easement |
| 0.49 | 1969 | Fred Brown | Gift of easement |
| 0.47 | 1969 | David Byors | Gift of easement |
| 0.03 | 1970 | Richard & Elizabeth Hosley | Gift of easement |
| 0.01 | 1970 | Chester & Barbara Nourse | Gift of easement |
| 0.002 | 1970 | Marvin & Alicia Pocharski | Gift of easement |
| 0.01 | 1970 | William & Rebecca Seaver | Gift of easement |
| 0.04 | 1970 | Bruce & Sarah Schwoeghler | Gift of easement |
| 1.25 | 1970 | Lauria & Risti | Purchase |
| 0.25 | 1970 | Bouchard | Purchase |
| 1.50 | 1976 | Russell W. Knight | Gift |
| RAM ISLAND | | | |
| 5.5 | 1976 | Ethel Walsh McEntee | Gift of easement |
| | | Dorothy Walsh Sullivan | |
| ROBINSON FARM | | | |
| 3.15 | 2005 | Fred and Rebecca Robinson | Purchase |
| TURNER WOODS | | | |
| 1.15 | 2009 | Town Land | Conversion to conservation land |

Appendix D: Required Maps

D1: Basic Map of Marblehead



D2: Soils of Marblehead

D3: Unique Features Map

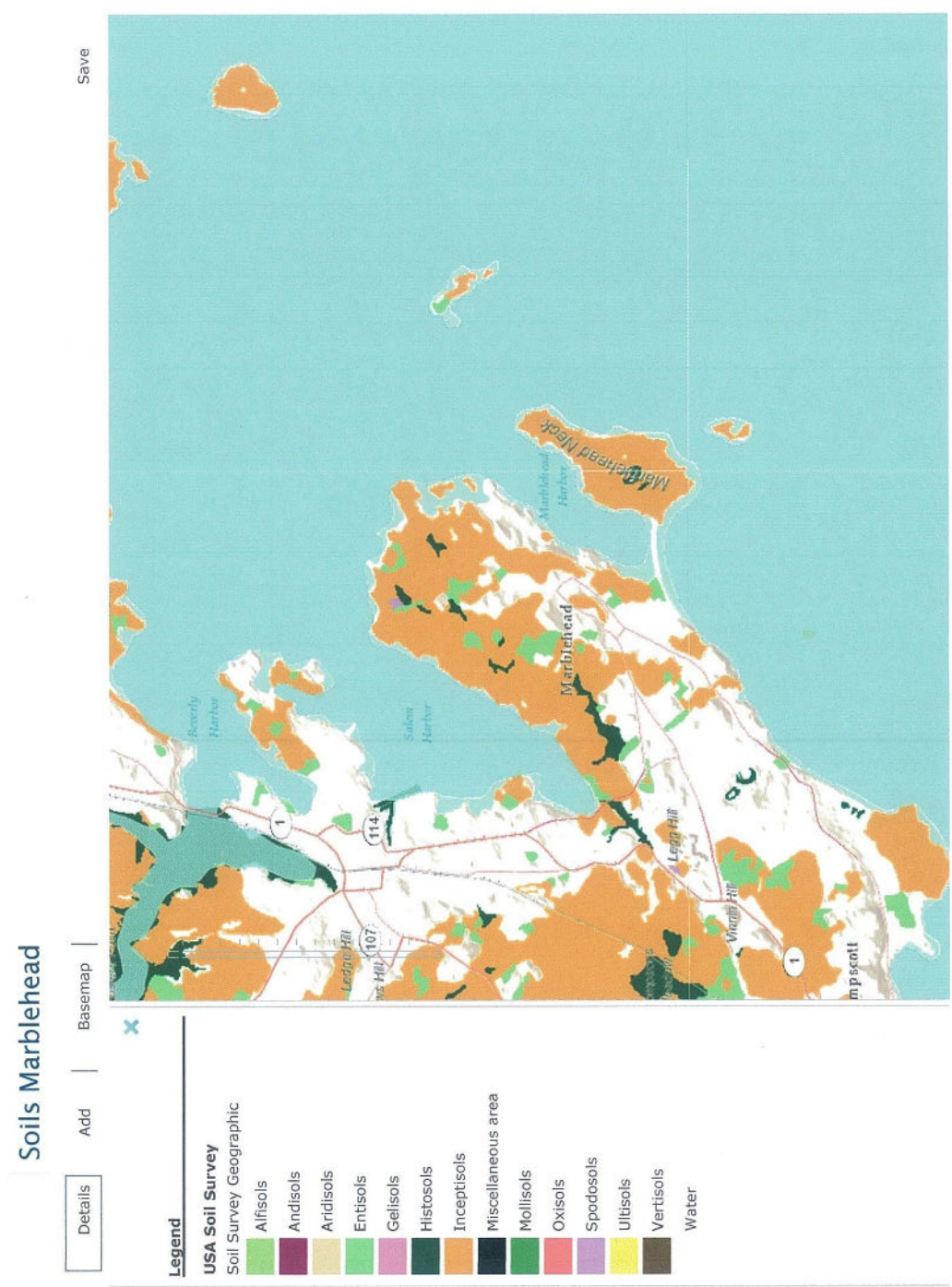

D4: Watershed and Related Maps (see Text Section 4A, for Watershed Map)

D4a: Zoning Map

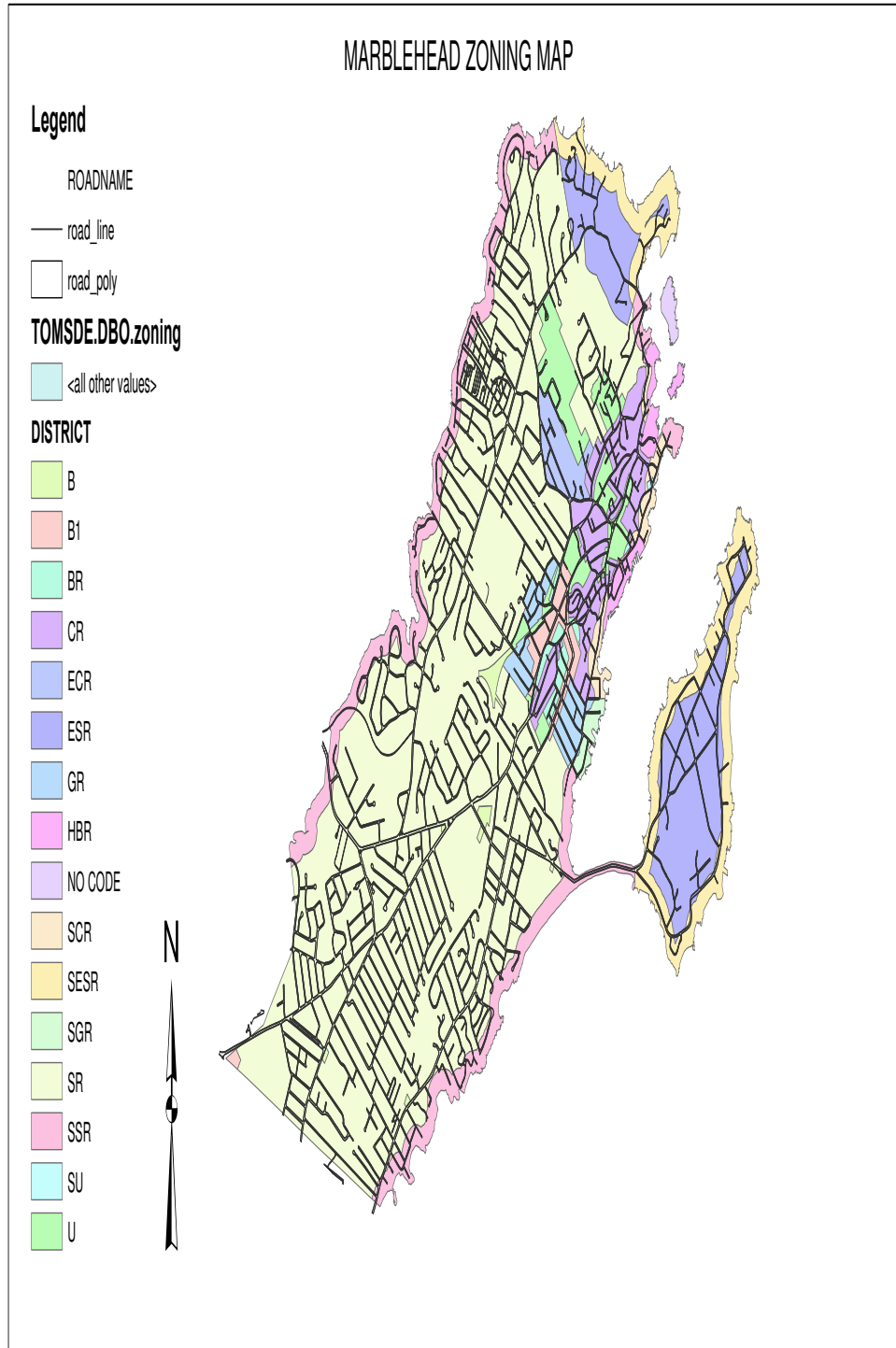

D4b: Flood Zoning Map



D4c: Wetlands Map

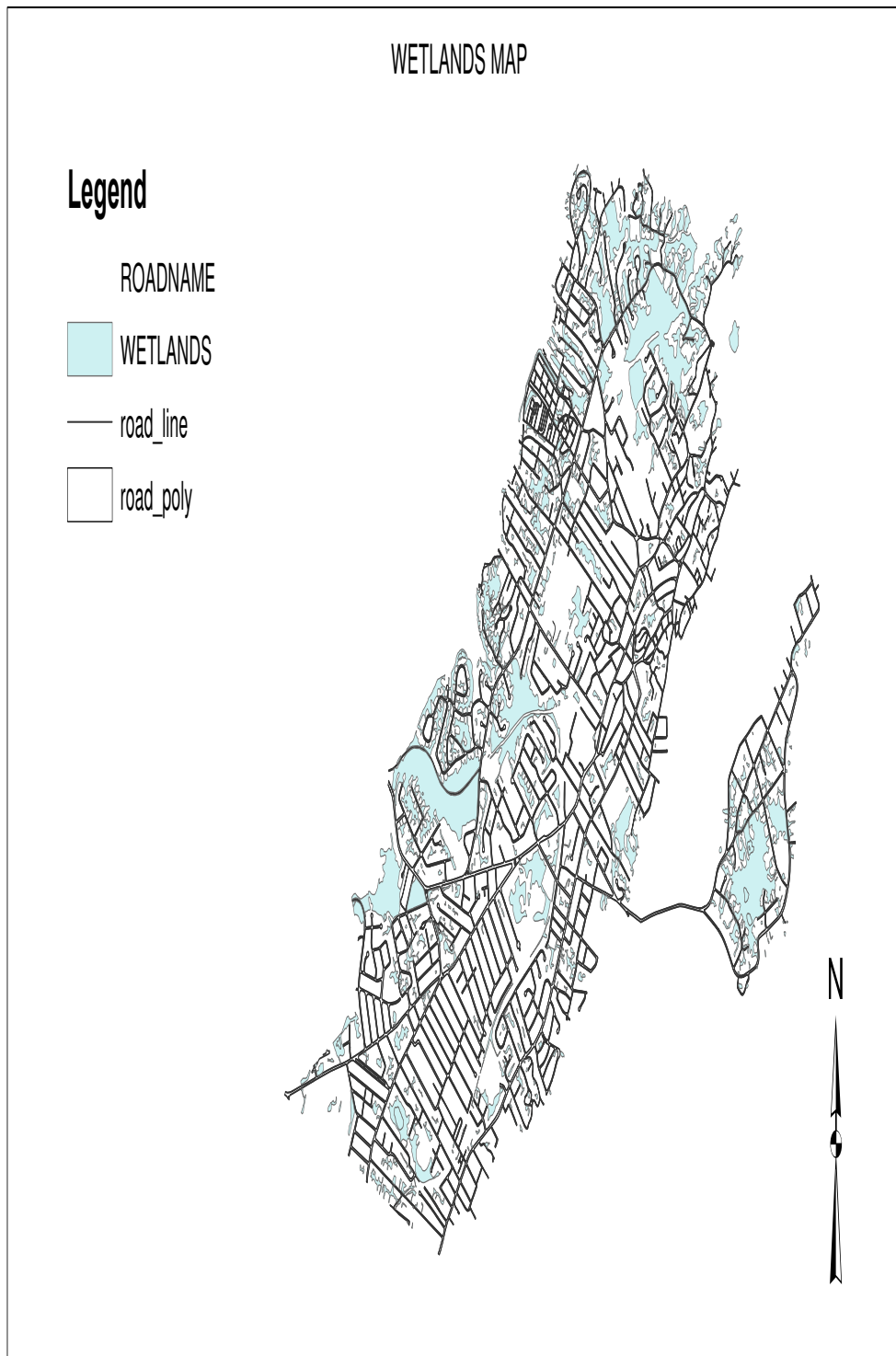

D5: Open Space Inventory Map (MA GIS Data)

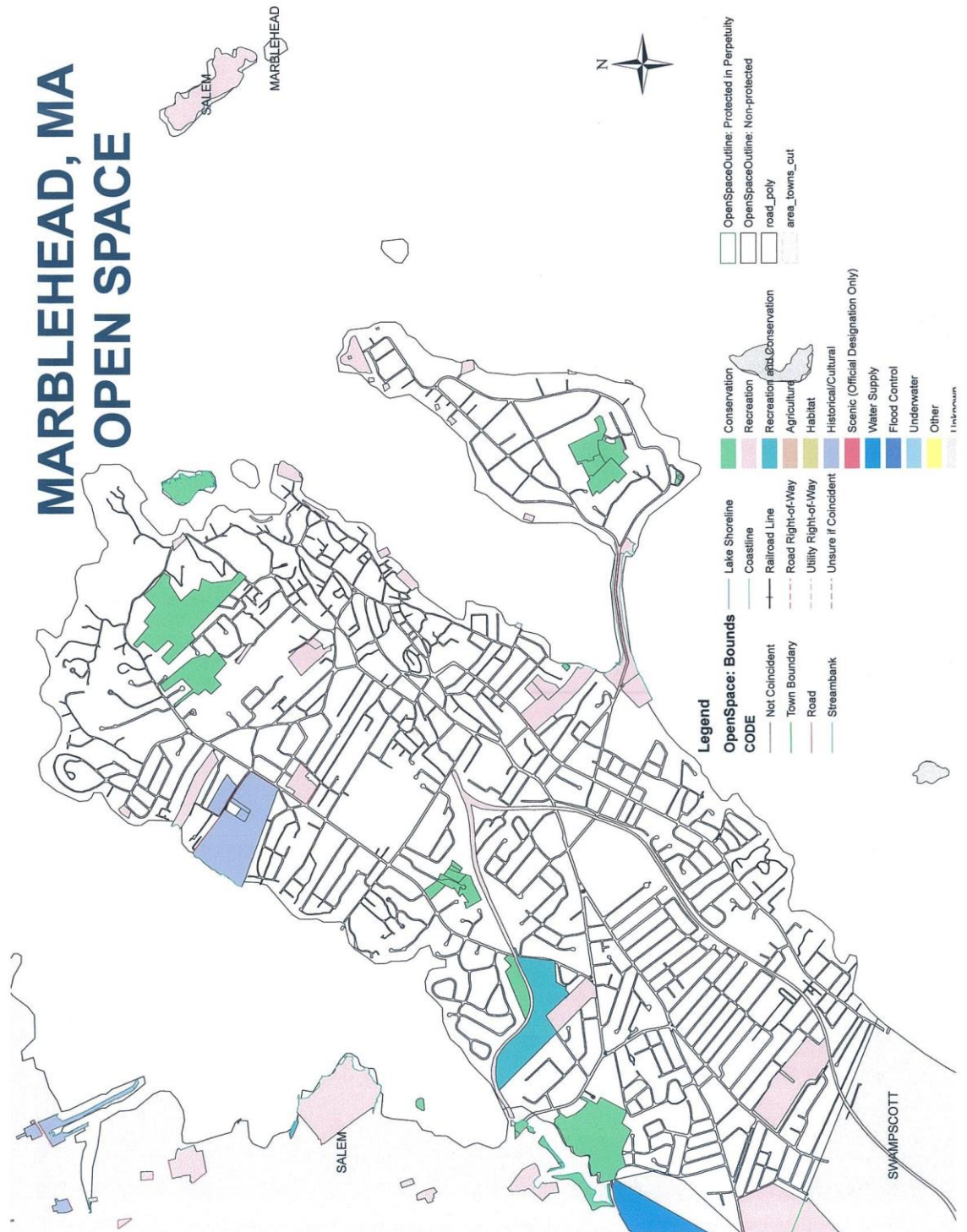

D6: Action Plan Map

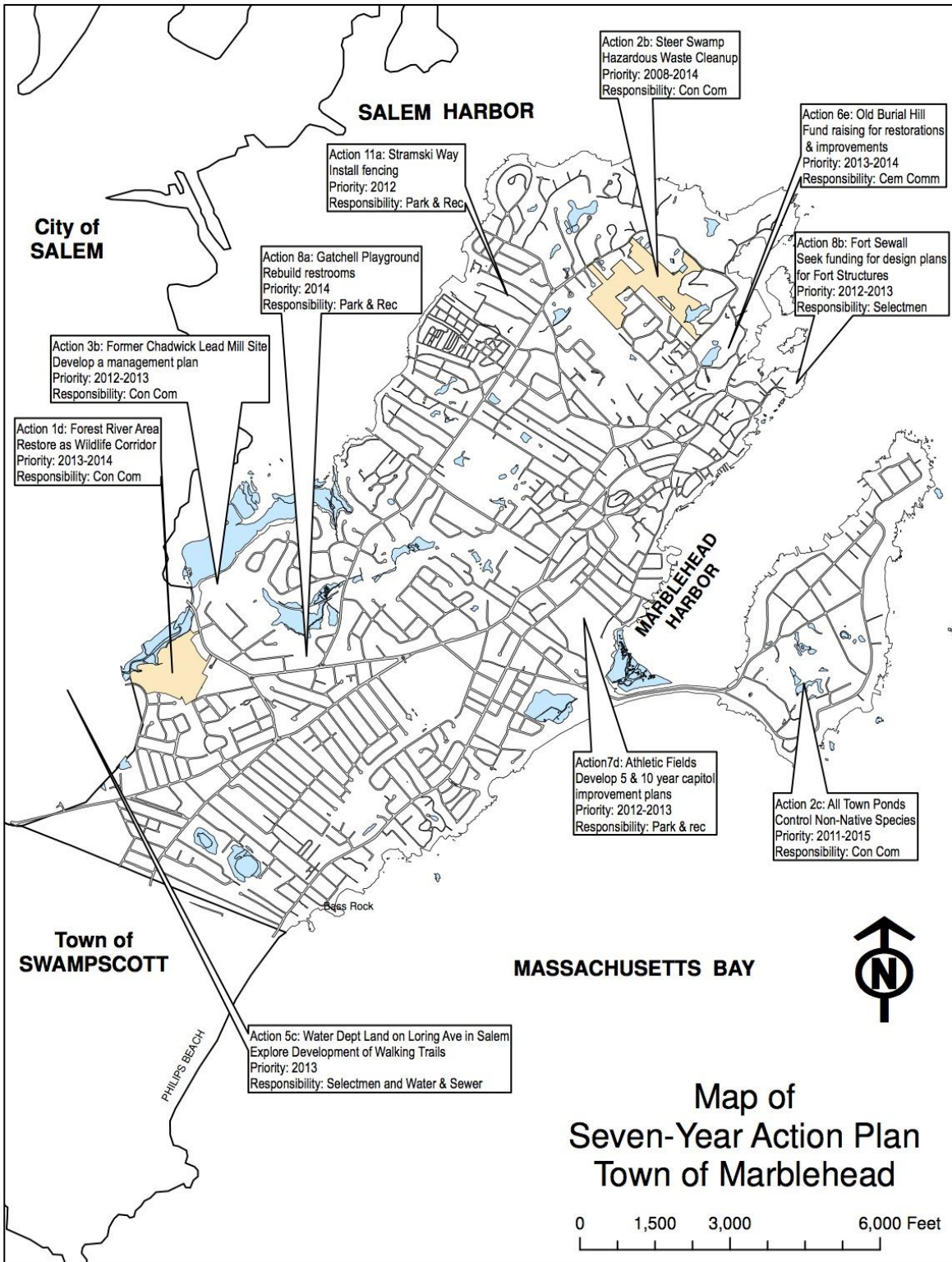

Note: These conservation area maps are available for free downloading from the web site of the Marblehead Conservancy, www.marbleheadconservancy.org.

E1: Forest River –



FOREST RIVER

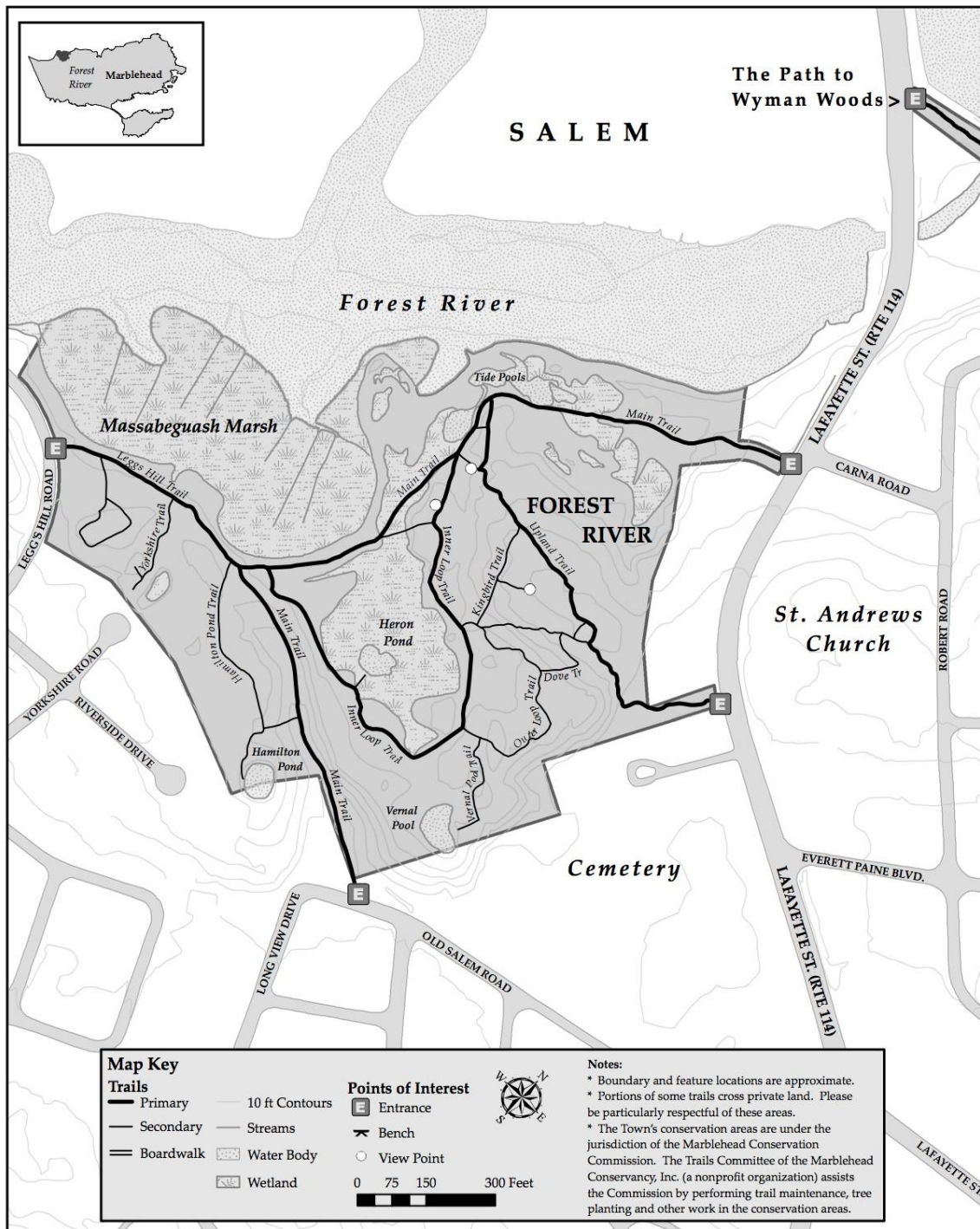

E2: Hawthorn Pond –

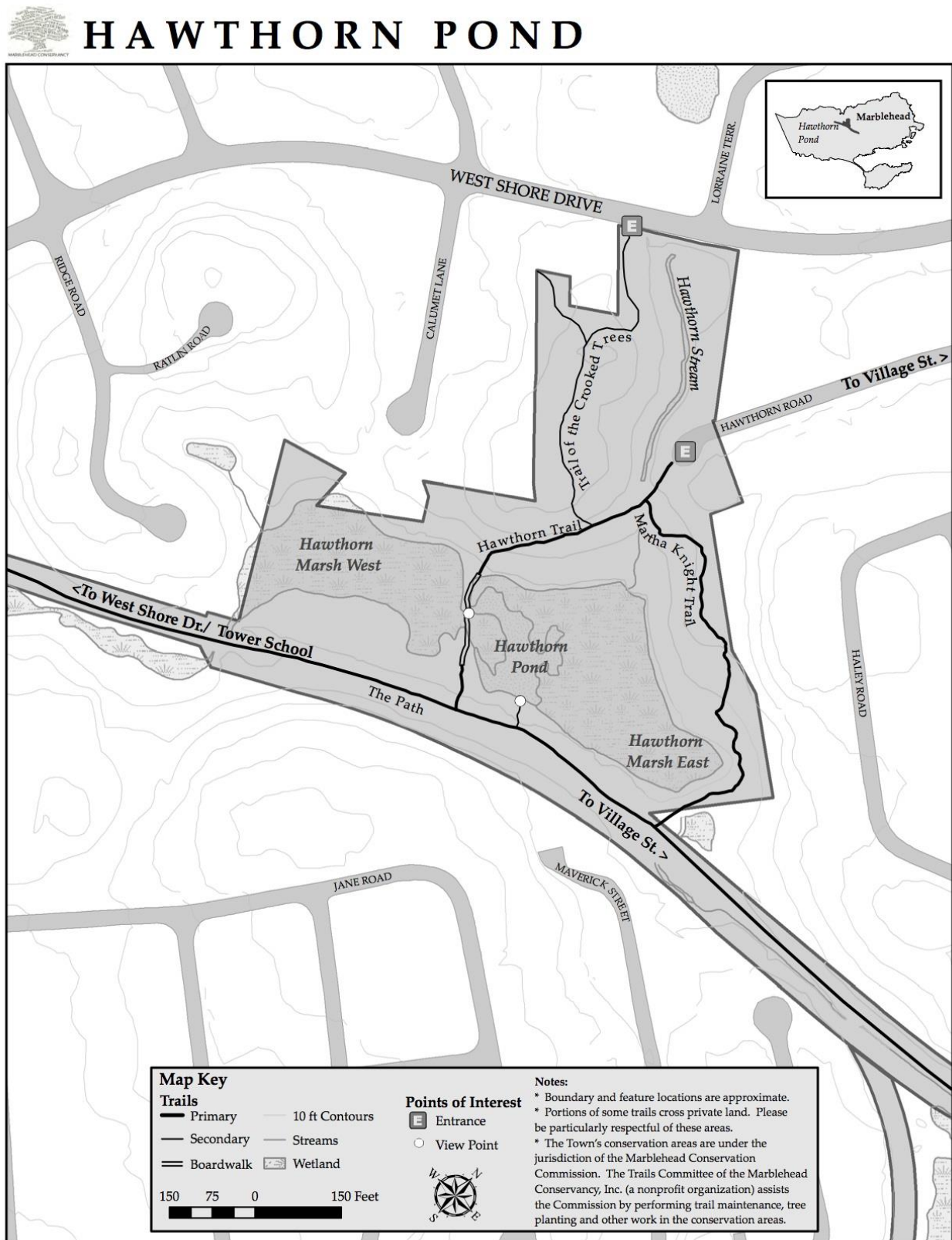

E3: Robinson Farm -

ROBINSON FARM

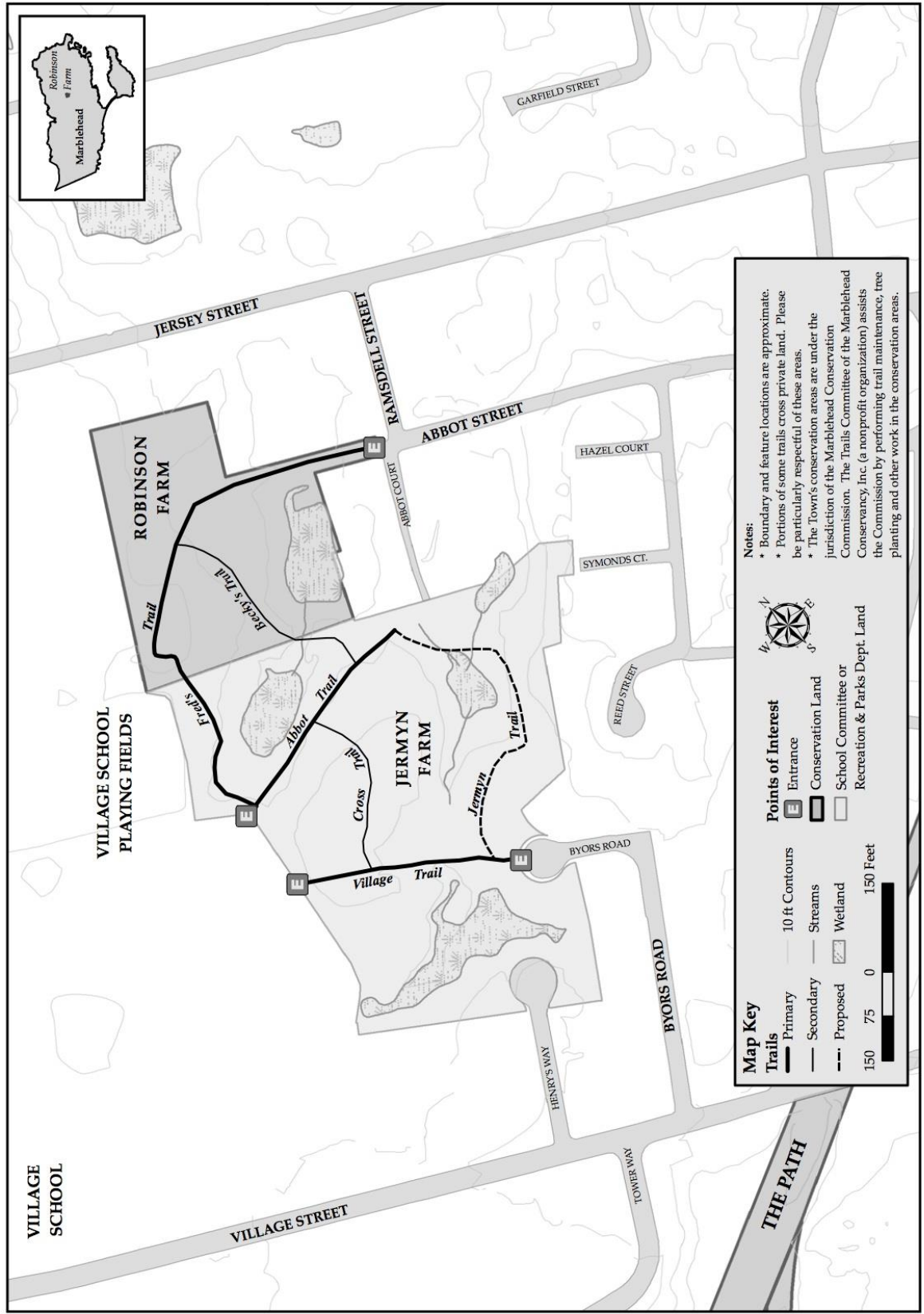

E4: Steer Swamp –



STEER SWAMP

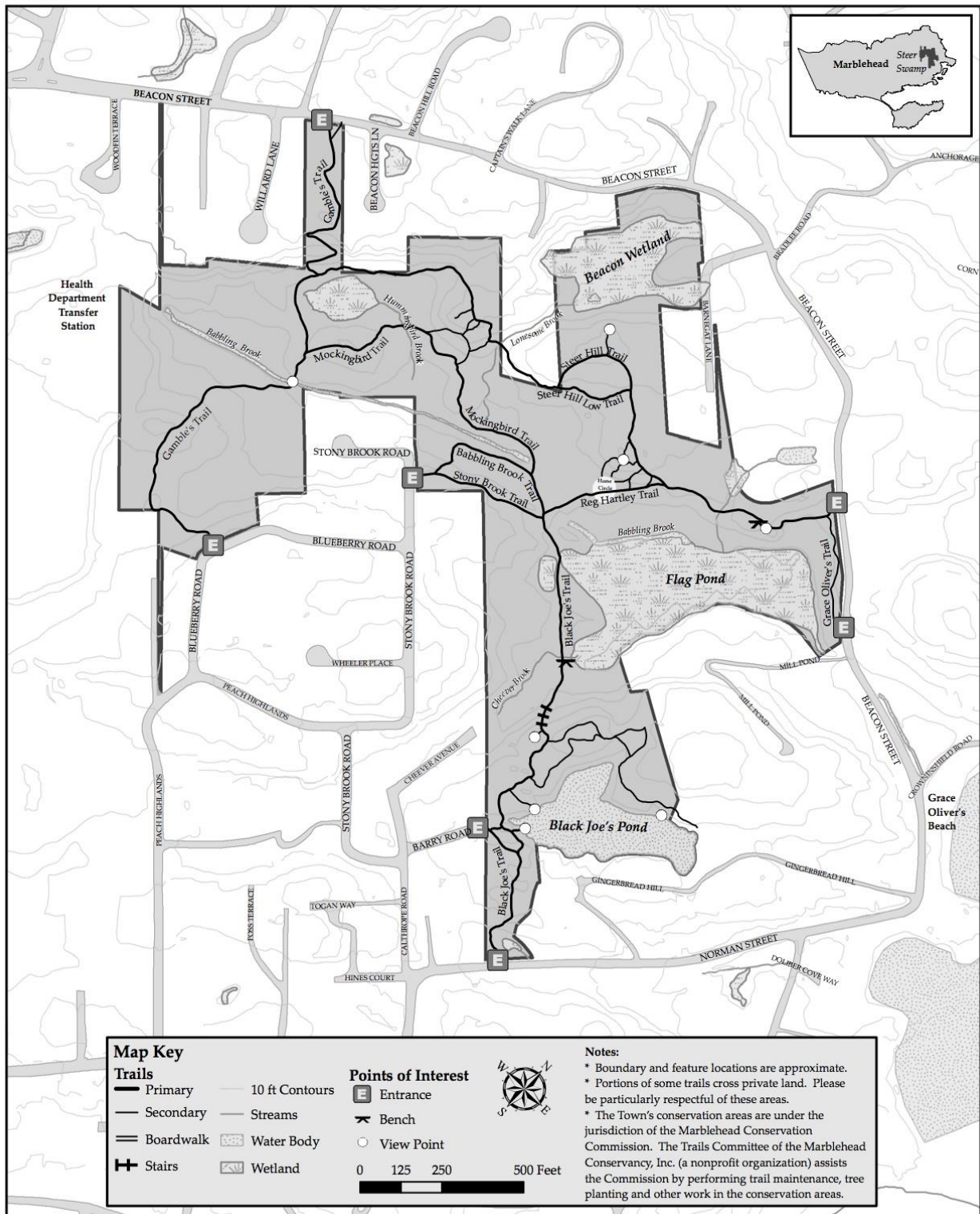

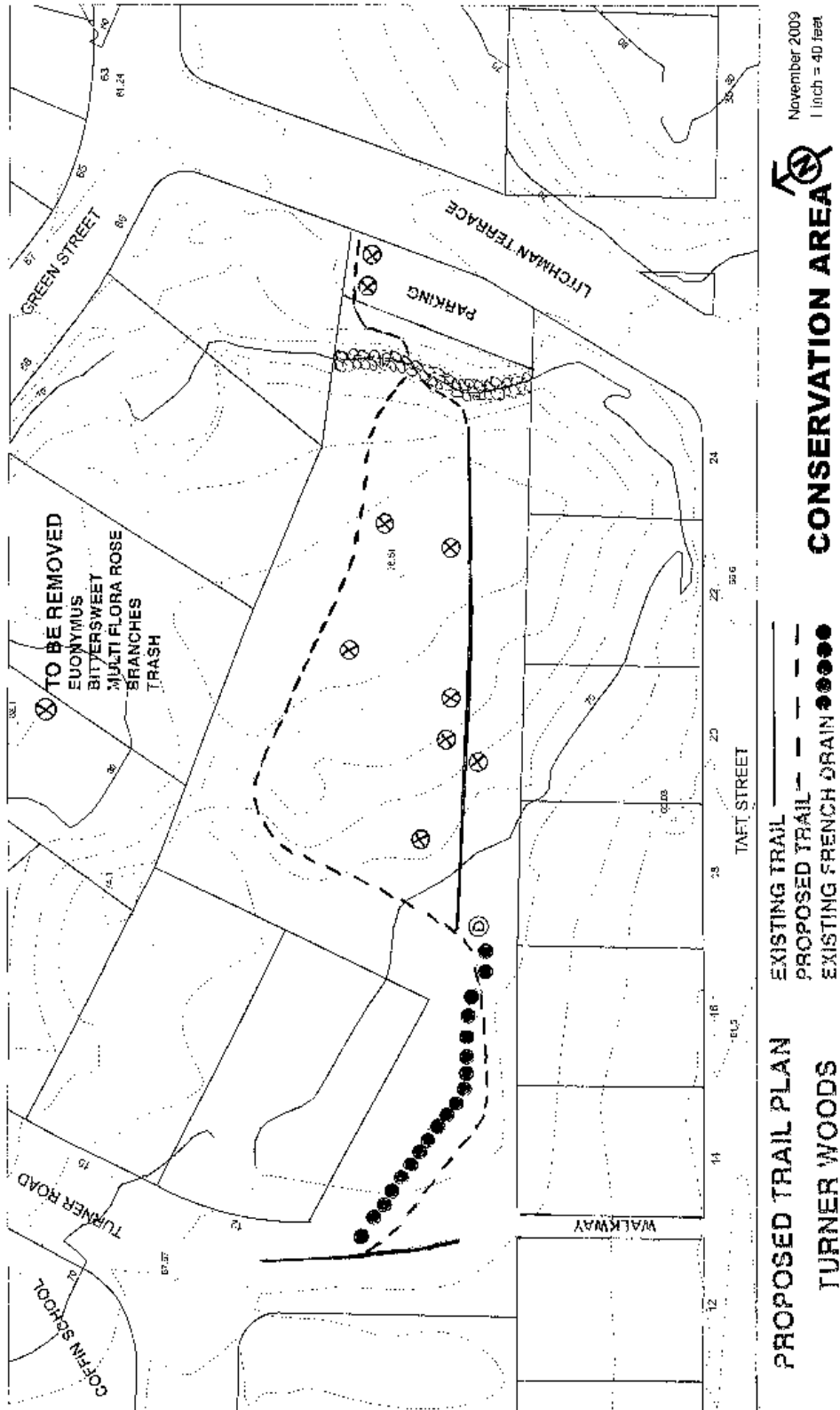



WARE POND

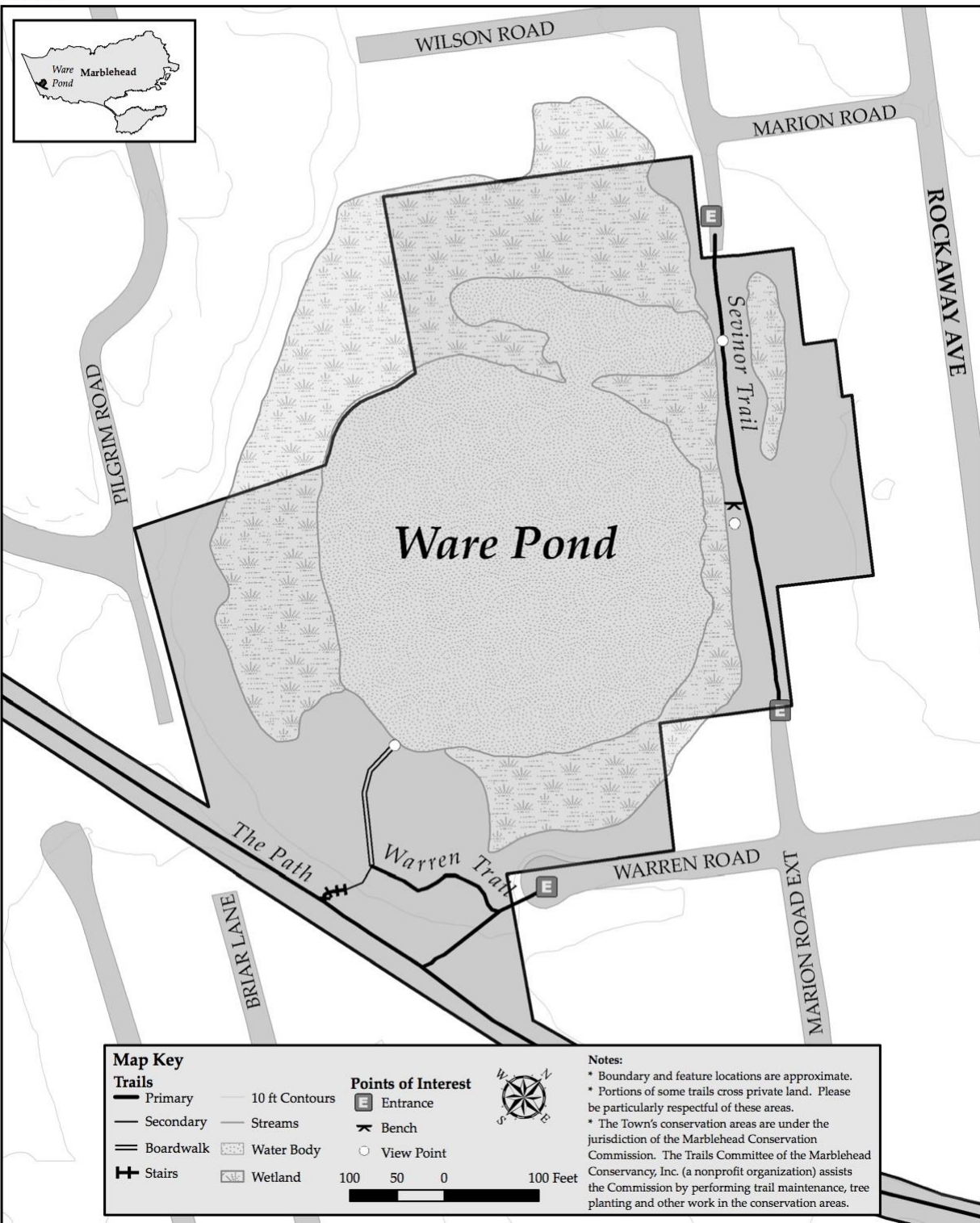



WYMAN WOODS

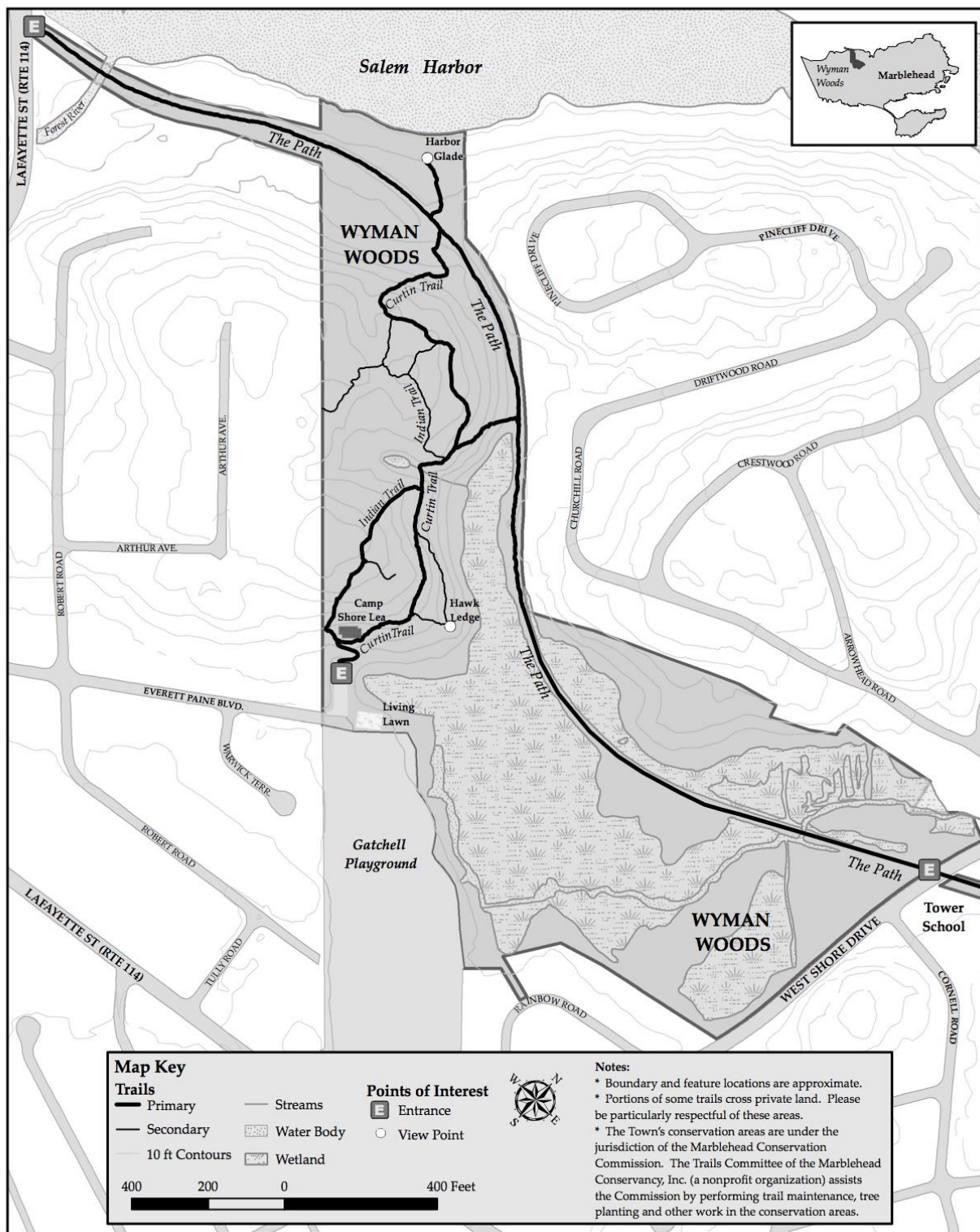

F1: Marblehead Reporter, February 22, 2012 –

“Marblehead — The Marblehead Open Space and Recreation Plan Study Committee is asking for residents’ input. Does Marblehead have enough recreation space, or conservation land? Are there enough areas that provide access to the coast? What public lands do you use regularly?

These are the sort of questions committee members want answered in a new survey they have posted on the **town website**. Paper copies of the survey are also available at Abbot Hall, Abbot Library and the Community Center.

The committee was formed in order to update the open recreation plan, which the town is supposed to file with the state every five years. The last time it was updated was in 1999, and 1988 before that.

The committee consists of members from the Recreation and Park Department, Conservation Commission, the Conservancy, as well as the Town Planner Becky Curran and resident Judy Anderson.

“At this point, we’re in the data-collection phase,” said Curran. “We held a workshop, and we reached out to all the relevant department heads and all the relevant organizations, of which there are about 66. The purpose of the survey is to try to get the general public’s ideas about what works and what’s good about open space, what’s needed, what’s lacking. It’s been very interesting, we’ve received interesting suggestions.”

The survey will be online until about mid-March.

F2: Marblehead Patch, April 4, 2012

Committee to Present Space Survey Results

The Open Space and Recreation Plan Update Committee will announce the results of a recently- completed survey and study Monday night. April 4, 2012

Related Topics: [Marblehead Community Center](#) and [Marblehead Recreation Plan](#)



The following information was submitted by Marblehead Town Planner Rebecca L. Curran:

The town's Open Space and Recreation Plan Update Committee is holding a meeting to announce the results of a recently-completed survey focused on making the best use of available space in town.

Full information about the survey was post on Marblehead Patch in early February and is available [here](#). The group's presentation will be made on Monday April 9, from 7 to 8 p.m. in the dining room of the **Marblehead Community Center** on Humphrey

Street. The information will be presented graphically and will provide an update on where the plan is headed.

F3: Marblehead Reporter, April 26, 2012 –

“Marblehead — Ever since the cleanup of the once-contaminated Chadwick Lead Mill site was completed last fall, the question has lingered: What will become of the land? Marblehead Town Meeting voters will get the chance to have their say in less than two weeks, as the Board of Selectmen is recommending an article proposing a Proposition 2 1/2 override to fund the purchase of the land from current owner, Glover Estates LLC.

The property, which rests at the Marblehead-Salem line on Lafayette Street, now boasts beautiful grass lawns overlooking the ocean, and town officials hope to turn it into conservation land. Lead-impacted soils and sediments have been removed and replaced with new trees, shrubs and salt-marsh vegetation.

“Now that the land is cleaned up, an appraisal was done, and we negotiated with the help of Essex County Greenbelt since part of the land is in Salem and part is in Marblehead,” explained Town Planner Becky Curran.

According to Curran, the bulk of the land — 3.46 acres to be exact — is in Marblehead. The land was appraised at \$2 million, but will be offered to Salem and Marblehead for the price of \$1.6 million, far less than the fair market value, according to Curran. Marblehead will cover \$1.5 million of this amount, and the median single-family household will be responsible for \$10.57 over 20 years.

As with all Proposition 2 1/2 override proposals, the article will need to gain the support of a two-thirds majority of those attending Town Meeting and then a simply majority of voters in a town-wide referendum, likely to be scheduled sometime in June.

“Unlike other overrides, land acquisitions are different,” said Curran. “One, because you can’t wait, the opportunity could be gone; and two, the price tends to be less in a down economy.”

The town is looking to apply for a PARC (Parkland Acquisitions and Renovations for Communities) grant due July 2, from which the project could receive up to a \$400,000 reimbursement from the Executive Office of Environmental Affairs, according to Curran. Normally a town with under 35,000 residents would only be eligible to apply for up to a \$50,000 reimbursement, but since Marblehead would be working with Salem to manage the land, the project may apply for the maximum reimbursement.

After an assisted-living center proposed for the site went by the wayside, Glover Estates struck a deal with KSS Realty Partners, which proposed to build a 44-unit condominium complex on the property under Mass. General Laws Chapter 40B. Eleven of the units (25 percent) would have been set aside as affordable housing.

But, according to Curran, “the owner is no longer interested in doing that on the site.”

Town officials hope to make part of the property a meadow, possibly serving as a trailhead for the railroad path and adding six to 10 parking spots.

An Open Space Survey was recently completed in town, asking residents to vote on what needs improvement. Most said they’d like to see more open space, as well as more access to the water, and Lead Mills would satisfy both elements.

“In the survey, over 60 percent of respondents said there is not enough open space. And this provides open space, as well as waterfront, and a majority of people said there’s not enough coastal access,” said Curran, who helped organize the survey. “It also links Wyman Woods, the bike trail, the path. It’s probably the one piece of land that has appeal to all the residents. It’s the gateway into Marblehead. Everyone sees this, and the impact of where it is to be developed would be so visual.”

Appendix G: ADA Self Evaluation

ADA Self Evaluation

I. ADMINISTRATIVE REQUIREMENTS

Part I.

1. Designated ADA Coordinator:

Kyle Wiley
Office of the Selectmen
Abbot Hall
188 Washington Street
Marblehead, Ma 01945
(781) 631-0000
(781) 631-8571
wileyk@marblehead.org

2. Grievance Procedure

The Town of Marblehead's grievance procedure is established to meet the requirements of the Americans with Disabilities Act.

This Grievance Procedure is established to meet the requirements of the Americans with Disabilities Act. It may be used by anyone who wishes to file a complaint alleging discrimination on the basis of disability in employment practices and policies or the provision of services, activities, programs, or benefits by the Town of Marblehead.

The complaint should be in writing and contain information about the alleged discrimination such as name, address, phone number of complainant and location, date and description of the problem. Alternative means of filing complaints, such as personal interviews or a tape recording of the complaint will be made available for persons with disabilities upon request.

The complaint should be submitted by the grievant and/or his/her designee as soon as possible but no later than 60 calendar days after the alleged violation to:

ADA Coordinator
Selectmen's Office
Abbot Hall
188 Washington Street
Marblehead, MA 01945
781-631-0000

Within 15 calendar days after receipt of the complaint, the ADA coordinator will meet with the complainant to discuss the complaint and possible resolutions. Within 15 calendar days after the meeting, the ADA coordinator will respond in writing, and, where appropriate, in a format accessible to the complainant, such as large print,

Braille, or audio tape. The response will explain the position of the Town of Marblehead and offer options for substantive resolution of the complaint.

If the response by the ADA coordinator does not satisfactorily resolve the issue, the complainant and/or his/her designee may appeal the decision of the ADA coordinator within 15 calendar days after receipt of the response to the Town Administrator or his or her designee.

Within 15 calendar days after receipt of the appeal, the Town Administrator or his or her designee will meet with the complainant to discuss the complaint and possible resolutions. Within 15 calendar days after the meeting the Town Administrator or his or her designee will respond in writing, and, where appropriate, in a format accessible to the complainant, with final resolution of the complaint.

All written complaints received by the ADA coordinator, appeals to the Town Administrator or his or her designee, and responses from the ADA coordinator and the Town Administrator or his or her designee will be kept by the Town of Marblehead for at least three years.

3. Public Notification Requirement

The town of Marblehead disabilities commission maintains a website www.marbleheadable.org which provides residents with notification. This information is also available in written forms including large format upon request.

4. Participation of individual with disabilities or organizations

The Marblehead Disabilities Commission, formerly the Selectmen's Advisory Committee on Disabilities, was formed at 2004 Town Meeting. The Committee had been in existence for more than 10 years advising the Selectmen on any issues concerning the handicapped and accessibility in the public sector. We currently consist of eight members. The Marblehead Disabilities Commission meets regularly on the second Thursday of each month at the Marblehead Community Center and welcomes any interested citizens to attend. The meetings are posted at Abbot Hall. The commission reaches out and provides resources for individual and organization with disabilities.

Part II Program Accessibility

Inventory and transition plan of all facilities and programs under the jurisdiction of conservation commission and recreation and park commission.

PARKS & RECREATION

Castle Rock - *partially accessible*

- has no parking facility at all
- Entrance is accessible
- Pathway is accessible

- Benches on accessible pathway
- Rock is not accessible

Chandler Hovey Park - *accessible*

- Park accessible
- Restrooms accessible
- 2 Hp parking spaces one van accessible both properly marked
- Benches accessible
- Pavilion is not accessible

Crocker Park – *partially accessible*

- 1 HP space not proper – slope exceeds 5%
- Benches and pavilion accessible

Devereux Beach – *accessible*

- 8 Hp spaces van accessible properly posted
- Floating swim chair available on site
- Mobility mat leads from accessible walkway to beach into water
- Benches accessible
- Pavilion accessible
- Grills need to be made accessible
- Playground equipment not accessible

Devereux Beach Concession – accessible

- Privately operated – town owned
- Accessible restrooms
- Accessible ramp access with railings
- Accessible seating

Fort Sewall – *partially accessible*

- Accessible restrooms
- Accessible signage
- Fort ramparts need to be made accessible

Fountain Park – *not accessible*

- Cannot be made accessible due to topography and site limitations
- Interpretive Signage could be installed and made accessible

Gatchell Playground – *partially accessible*

- 2 HP parking spaces 1 van accessible properly psoted and signed
- No accessible restrooms
- Concession stand not accessible
- improvements in all areas needed

Gerry playground – *not accessible*

- no hp parking
- playground equipment not accessible
- new pier is accessible but no accessible path to reach
- improvements in all areas needed

Hobbs playground – *not accessible*

- improvements in all areas needed

Memorial Park - *accessible*.

- Recently went through a major renovation.

- Need accessible drinking fountains

Orne Playground – *not accessible*

- Off road unlined parking lot no HP spaces
- No access to ball field
- Playground equipment not accessible

Redd's Pond – *partially*

- No parking lot
- Accessible curbcuts and path
- Accessible picnic table

Reynolds playground – *not accessible*

- Restrooms not accessible
- Hockey rink not accessible
- Softball field not accessible
- Area I underwater at certain times of year
- Lack of accessible route through park
- Improvements in many areas needed

Riverhead Beach – *somewhat accessible*

- Paved surface
- Accessible to boat ramp
- No restrooms
- No other features

Seaside Park - *partially accessible*

- Restrooms not accessible
- Park is accessible through private church parking lot adjacent
- Grandstand no accessible
- Playground equipment not accessible
-

Recreation Programs

- Indoor programs are held in the Marblehead Community center which is accessible
- Programs are accessible on computer for accessible reading
- Outdoor programs held in parks are not accessible
- Fields requires an accessible route

Conversation Land and Trails

Forest River – *not accessible*

- No parking lot
- Trails not accessible

Hawthorn Pond - *not accessible*

- No parking lot
- Trails not accessible

Steer swamp - *not accessible*

- No parking lot
- Trails not accessible

Ware pond accessible

- No parking lot
- Trails accessible wooden boardwalk leads to a viewing area of the pond.

- Flat rest stops are every few feet and the path has a gentle and wheel-able slope.

Wyman Woods

- No parking lot
- Trails not accessible

Part III. Employment Practices

ADA coordinator certification:



Office of the
BOARD OF SELECTMEN
ABBOT HALL
188 Washington Street
MARBLEHEAD, MASSACHUSETTS 01945

Jackie Belf-Becker, Chair
Harry C. Christensen Jr.
Judith R. Jacobi
Bret T. Murray
James E. Nye

Jeff Chelgren
Town Administrator

June 25, 2012

To whom it may concern:

I hereby certify as the ADA Coordinator that the Town of Marblehead is in compliance with the Americans with Disabilities Act in regards to the following:

Recruitment
Personnel Actions
Leave Administration
Training
Tests
Medical Exams/Questionnaires
Social and Recreational Programs
Fringe Benefits
Collective Bargaining Agreements
Wage and Salary Administration

Sincerely,

A handwritten signature in cursive script that reads "Kyle A. Wiley".

Kyle A. Wiley
ADA Coordinator
Town of Marblehead

Telephone (781) 631-0000 Fax (781) 631-8571

Appendix H: Letters of Review –